

PCA Supporters:

I had an interesting morning at the park recently. While my 8-year-old was playing, I became fixated on a giant oak that was shading where I sat. Suddenly, a large commotion caught my attention. Two squirrels engaged in a battle. It ended quickly, with one chasing the other completely out of that oak. Just a few branches over, there were two birds locked in a similar battle over a specific branch. It was clear that both battles were over space. This resonated with me because I couldn't help but think... The PCA is facing a battle over some new space, too.

I'm pleased to announce the PCA is making a concerted effort to acquire approximately 12 acres of land for public use. The ultimate goal is to create an extension of the David Canny Rountree Branch Trail that runs along an old railroad bed. We envision this space to have scenic views and a peaceful ambiance. The acquisition also adds a parcel on Valley Road west of the Dog Park that would serve as a future trailhead right in the center of our slice of nature.

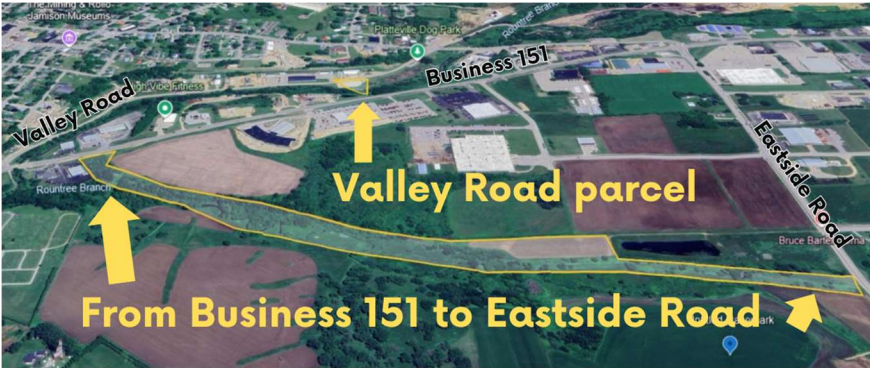

The attached exhibit shows where and what land we are trying to acquire. The landowners involved have been pleasant to work with and see the value this trail would bring to our community. The real fight is to raise funds for purchasing land, appraisals, closing costs, survey work, attorney fees, etc. This project is two years in the making, though the original idea has been around since 2010.

After applying for a grant months ago, we received word on September 10th from the Wisconsin Department of Natural Resources that a 50/50 grant of **\$136,700** was awarded to the PCA. That means we are already halfway toward our land acquisition goal!

This letter is to inform you of this exciting plan, to ask for your support, and hopefully, to make a financial contribution. Usually, our fall mailer asks for donations toward our endowment. This time we are focusing our efforts on our **Valley-to-Eastside Expansion Project**, and we hope you are supportive.

Our goal is to raise our half of the funds by the summer of 2025. We will be exploring all avenues, and please know that all donations are greatly appreciated. Any donations over \$1,000 will be recognized and displayed according to tiers in a **'Valley-to-Eastside Expansion Project'** kiosk.

I will close by underscoring the importance of green space to our community. In a world that lays more concrete every day, these natural areas are becoming more obsolete. This is why the PCA is 'fighting' for this land to preserve. This project, through a DNR alliance, will keep this area for all indefinitely.

Thank you, again, for supporting the PCA.

Joe Jacquinet
PCA president